

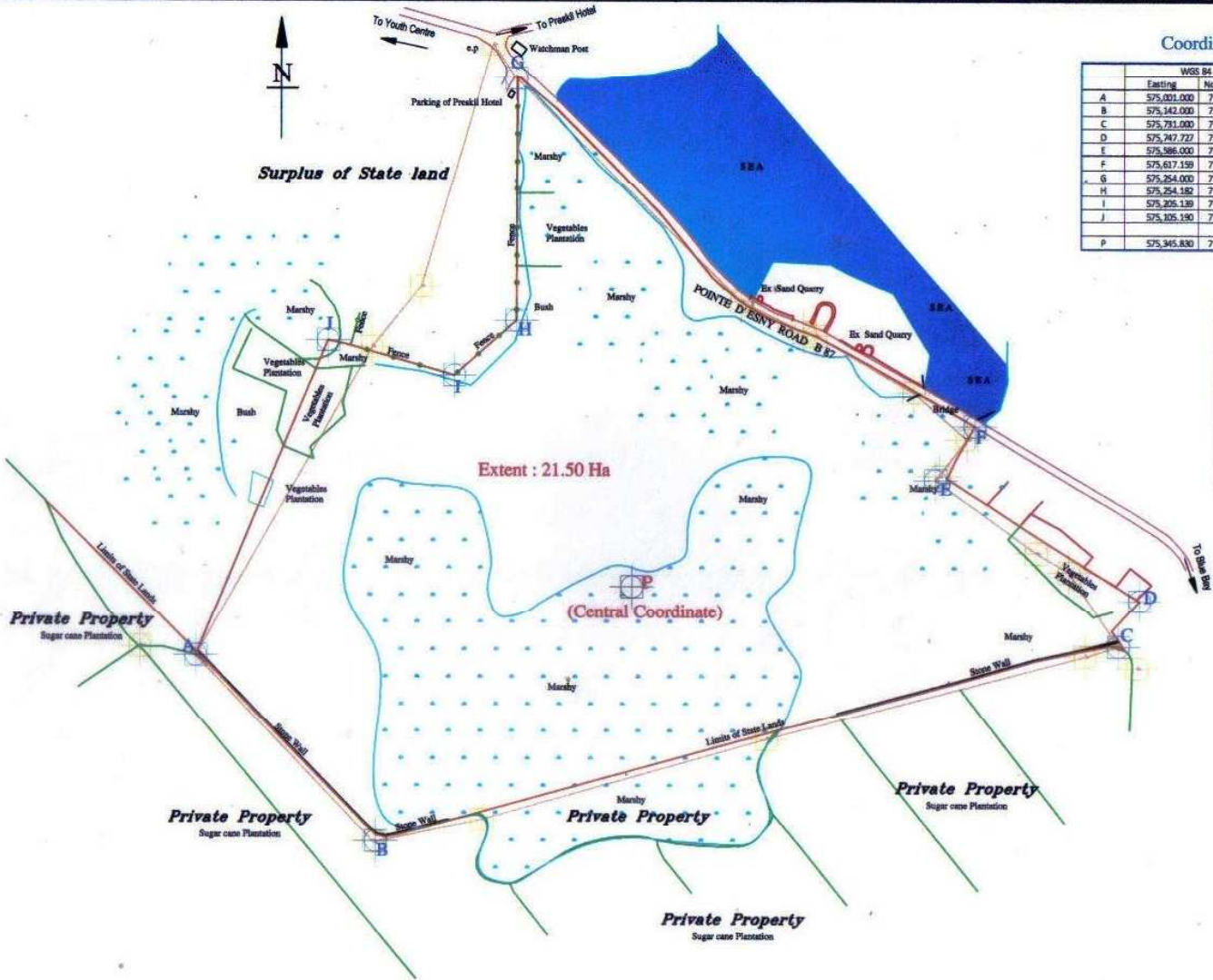

Surplus of State land



Coordinates

	WGS 84			
	Easting	Northing (v.e)	Latitude	Longitude
A	575,001.000	7741076.000	E57.72478	S20.42723
B	575,142.000	7740928.000	E57.72030	S20.42856
C	575,791.000	7741084.000	E57.72594	S20.42713
D	575,747.727	7741120.307	E57.72581	S20.42680
E	575,596.000	7741216.000	E57.72454	S20.42594
F	575,617.199	7741258.589	E57.72478	S20.42565
G	575,254.000	7741334.000	E57.72134	S20.42308
H	575,254.192	7741342.094	E57.72135	S20.424817
I	575,205.139	7741298.565	E57.72083	S20.425211
J	575,105.190	7741326.253	E57.71902	S20.424964
P	575,945.830	7741130.924	E57.72215	S20.42700

Legend

- GPS Points
- Boundary of Ramsar Site
- Marshy Lands
- Road
- Sea

MINISTRY OF AGRICULTURE AND FISHERIES
 & RURAL DEVELOPMENT
 Forestry Division

Pointe D'Esny Wetland

Date: September 2011 Scale: 1:5000
 Drawn at: Survey Office
 File No. C/Survey/149/1065/II